

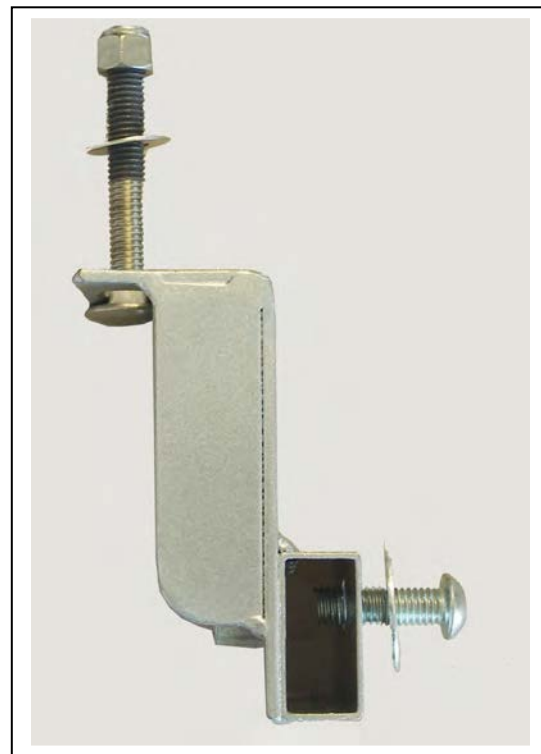

**Installation Instructions for Rear Stake Pocket Insert Boxes in 2014 and later GM Pickup Trucks** 30JUL16

The Rear Stake Pocket Insert Box Assembly is used in lieu of the stake pocket insert plate to anchor the base of a truck rack to the special hand grip stake pocket holes at the rear of the bedrails on 2014 and later full size GM pickup trucks and 2015 and later compact GM pickup trucks. Fig. 1 shows the parts of the assembly. If after inventorying your parts you are missing parts, contact U.S. Rack immediately at 1-888-877-2257. **DO NOT INSTALL THIS PRODUCT WITHOUT FOLLOWING ALL INSTRUCTIONS.** Note that the type of nut and the length of the carriage bolt that extend out the top of the stake pocket may vary depending upon the type of rack to which it connects. Fig. 2 shows how the screws, washers and nuts connect to the box.

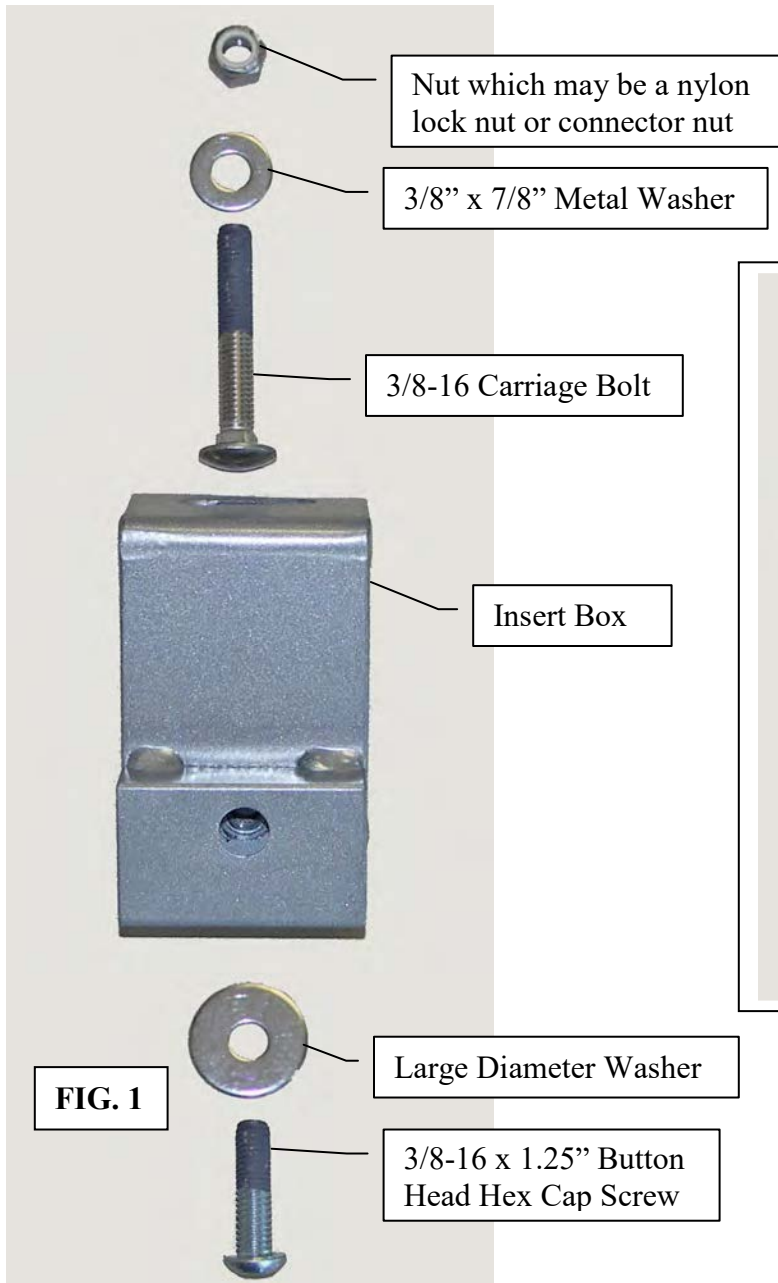

**FIG. 2**



As shown in Fig. 3, insert the carriage bolt up through the bottom of the slot in the box, place the standard metal washer onto the bolt and then screw the nut some ways down onto the screw so you can get a good grip on it. If it is already installed, remove the button head hex cap screw and large washer from the side of the box and lower the box down into the top of the rear stake pocket. Align the hole in the side of the box with the hole on the inside of the stake pocket that leads to the bed. After placing the large washer onto the screw insert the end of the screw through the hole in the side of the stake pocket and into the hole in the side of the box. Twist the screw into the threads and tighten until the screw it runs into the nylon ring on the nut and gets hard to turn. Use the Allen wrench to tighten it firmly. As shown in Fig. 4, once the box is firmly in place, the carriage bolt should provide a good platform onto which your rack can be connected.

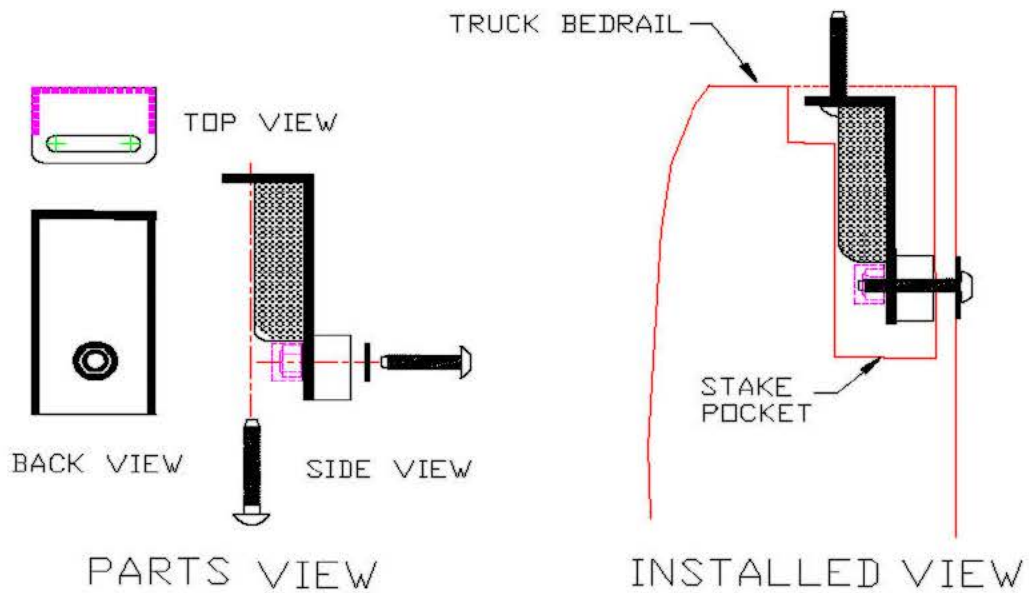

**FIG. 3**

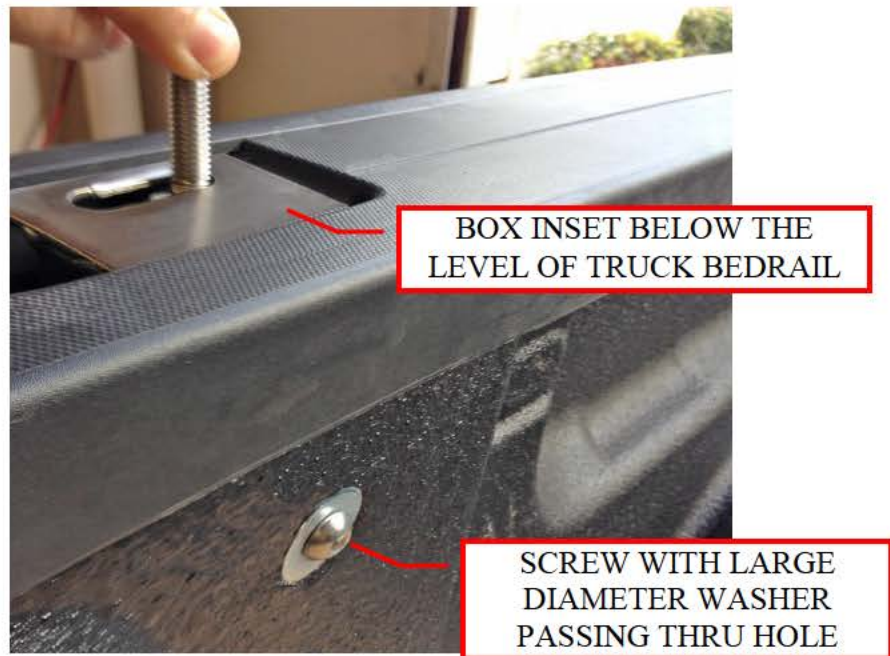

**FIG. 4.**